

ALIGNMENT 375MM  
H-SCALE 1:500,  
V-SCALE 1:100

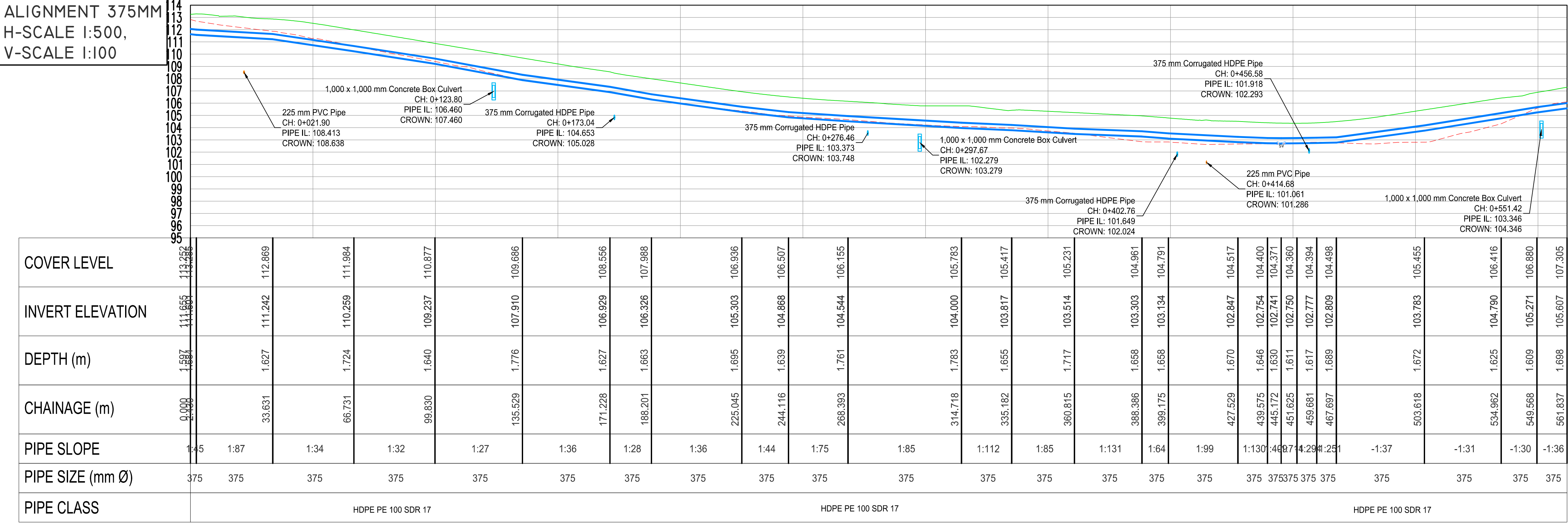

375mm PE WATERMAIN DIVERSION - LONG SECTION

ALIGNMENT 450MM  
H-SCALE 1:500,  
V-SCALE 1:100

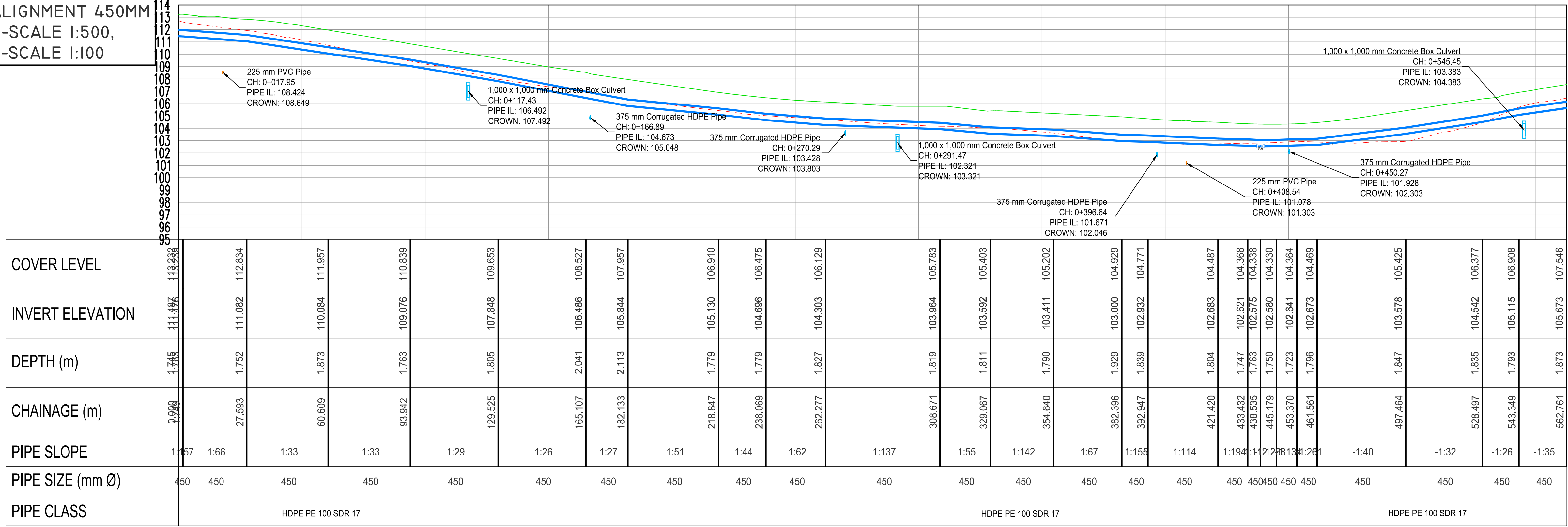

450mm PE WATERMAIN DIVERSION - LONG SECTION

GENERAL NOTES

- DO NOT SCALE THIS DRAWING. WORK ONLY TO FIGURED DIMENSIONS.
- FOR ALL RELEVANT NOTES, REFER TO STRUCTURAL AND CIVIL ENGINEERING PERFORMANCE SPECIFICATION.
- ANY DISCREPANCIES ARE TO BE REPORTED TO PINNACLE CONSULTING ENGINEERS IMMEDIATELY.
- THIS DRAWING IS TO BE READ IN CONJUNCTION WITH ALL OTHER RELEVANT ENGINEERS, ARCHITECTS AND SUB-CONTRACTORS DRAWINGS AND DETAILS.
- THIS DRAWING IS TO BE PRINTED IN COLOUR.
- THIS DRAWING IS NOT TO BE USED FOR CONSTRUCTION PURPOSES UNLESS EXPRESSLY STATED.
- EXISTING SITE AND LEVEL INFORMATION TAKEN FROM LAND SURVEYS TOPOGRAPHICAL SURVEY DRAWING D1728F2D DATED 04/10/06.
- THIS DRAWING HAS BEEN PREPARED USING THE PROPOSED SITE LAYOUT FROM DAVEY + SMITH ARCHITECTS DRAWING IP00 DATED 16/08/24.

LEGEND

- NEW DESIGN SURFACE LEVEL
- EXISTING GROUND LEVEL

WATERMAIN NOTES:

- ALL WATERMANS VALVES AND FITTINGS SHALL BE CONSTRUCTED IN ACCORDANCE WITH THE IRISH WATER STANDARD DETAILS AND IRISH WATER CODE OF PRACTICE FOR WATER INFRASTRUCTURE.
- ALL WATERMANS SHALL BE HDPE, PE100, SDR17 TO IS EN 12201 PART 2:2011 AND IS EN 12201-3:2011.
- CONNECTION BETWEEN EXISTING AND PROPOSED WATERMANS TO BE CARRIED OUT IN ACCORDANCE WITH IRISH WATER STANDARD DETAILS STD-W-03 TO STD-W-10.
- ANCHOR BLOCKS TO BE POSITIONED AT DEAD ENDS, TEES, BENDS AND AT EACH SIDE OF HYDRANTS AND VALVES IN ACCORDANCE WITH THE REQUIREMENTS OF IRISH WATER STANDARD DETAIL STD-W-28 (WATER MAIN THRUST AND SUPPORT BLOCKS).DISMANTLING JOINTS TO BE INSTALLED AT EACH SLUICE VALVE AS PER IRISH WATER STANDARD DETAIL STD-W-15.
- INSTALLATION OF SLUICE VALVES, AIR VALVES AND HYDRANTS SHALL BE IN ACCORDANCE WITH IRISH WATER'S STANDARD DETAILS STD-W-14 TO STD-W-23.
- MARKER POSTS AND PLATES ARE TO BE PROVIDED IN ACCORDANCE WITH IRISH WATER STANDARD DETAIL STD-W-27.
- CONNECTION TO EXISTING WATERMANS TO BE COORDINATED BY THE CONTRACTOR WITH IRISH WATER AND/OR THE LOCAL AUTHORITY.
- CONTRACTOR TO LIASE WITH IRISH WATER AND / OR THE LOCAL AUTHORITY AS REQUIRED REGARDING TESTING, CLEANSING AND STERILISATION OF WATERMANS
- WATERMANS TO BE PRESSURE TESTED IN ACCORDANCE WITH THE REQUIREMENTS OF IRISH WATER AND IGN 4-01-03, GUIDE TO TESTING OF PRESSURE PIPES AND FITTINGS FOR USE BY PUBLIC WATER SUPPLIERS. OCTOBER 2015. A FORMAL TEST REPORT SHALL BE SUBMITTED TO THE ENGINEER DETAILING THE TEST CARRIED OUT.

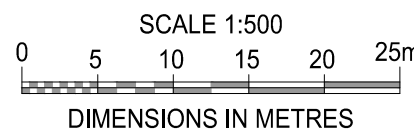

P01 ISSUED FOR PLANNING FJVR JB 02/09/24

REV	DESCRIPTION	BY	CHK/APP	DATE

CLIENT

PROJECT  
OLDCOURT LRD

DRAWING TITLE  
WATERMAIN DIVERSION  
LONG SECTIONS

**PINNACLE**  
CONSULTING ENGINEERS

GROSVENOR COURT,  
61A PATRICK STREET,  
DUN LAOGHAIRE,  
COUNTY DUBLIN,  
IRELAND, A86 W3V7  
NORWICH ■ WELWYN GARDEN CITY ■ LONDON ■ THE HAGUE ■ FRANKFURT

DRAWING STATUS				
PLANNING				
SCALE @ A1	DATE	DRAWN BY	CHECKED	APPROVED
1:500	2024/04/28	FJVR	JB	SOR
DRG NO.	P211102-PIN-XX-XX-DR-C-00311-S2			REV. P01

COPYRIGHT PINNACLE